

DRAWING NUMBER: 86-127 REV: 3
 ECN NUMBER: 00-025

P/N	DESCRIPTION	QTY.
85-215	WIRE - LINKAGE - PIVOT ARM - ST	1
86-105	LOCK PLATE ASSEMBLY - LOW - LE - ST	1
86-132	PIVOT & ROLLER ARM ASSEMBLY - LOW - LE - ST	1
86-141	SOLENOID ASSEMBLY	1
③ 86-147	LOCKING BAR ASSEMBLY - ST	1
① SRHM#10-24X1	SCREW - MACHINE - PAN - #10 UNC x 1	2
NH#10-24	NUT - MACHINE SCREW - #10 UNC	2
WL#10 SPLIT	WASHER - HELICAL SPRING - REGULAR - #10	2
85-178	WASHER - THRUST - 3/8 x 3/4 x 1/16	2
85-177	WASHER - THRUST - 5/8 x 1 x 1/16	2
PC3/32X1/2	PIN - COTTER - 3/32 x 1/2	1
PC3/32/1	PIN - COTTER - 3/32 x 1	1

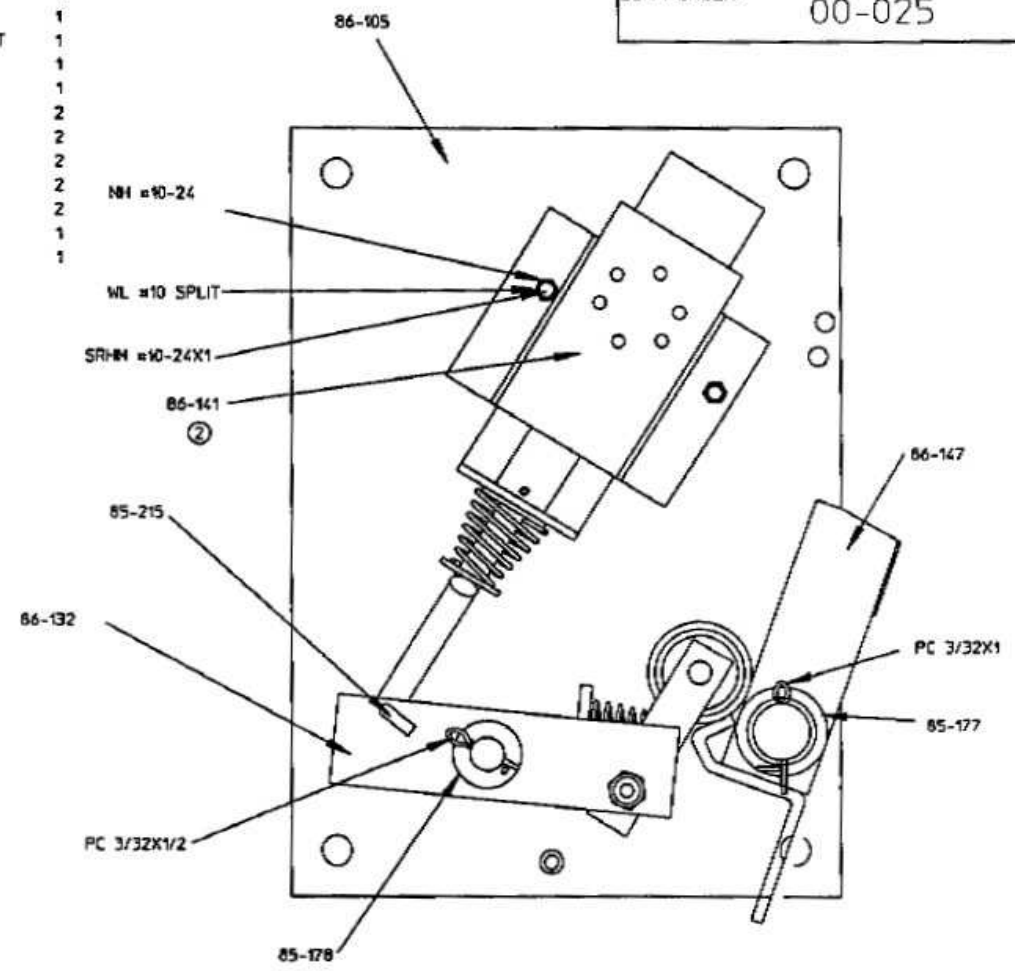

MATERIAL: *****
 FINISH: ****

REVISIONS				ALL DIMENSIONS ARE IN INCHES UNLESS SPECIFIED		Phillips CSS Inc 7041 Orchard Dearborn, MI 48128	
REV.	DESCRIPTION	BY	DATE	TOLERANCE UNLESS SPECIFIED		DRAWING TITLE:	
1	UPDATE HARDWARE PART NUMBER DESIGNATIONS	GVB	02/19/99	0.0	± 0.060	LOCKING MECHANISM ASSEMBLY - LOW - FAIL-LOCK	
2	RE-DRAWN AND ELIMINATED ISOMETRIC VIEWS. 86-141 WAS 86-137.	GLS	07/14/99	0.00	± 0.030	DRAWING NUMBER: 86-127 REV: 3	
3	Revised 86-147 Assembly	GVB	03/14/00	0.000	± 0.015	SIZE: A MODEL: ST	
				0.0000	± 0.005	DRAWING NUMBER: 86-127 REV: 3	
				ANGULAR	± 0.5°	SCALE: □ : □ ASSEMBLY ***** SHEET: 1 OF 1	
DRAWN BY/DATE: GLS 07/14/99				CHECKED BY/DATE: GVB 07/14/99			

THESE DRAWINGS & SPECIFICATIONS ARE THE PROPERTY OF AND PROPRIETARY TO PHILIPS INDUSTRIES, INC. AND ARE NOT TO BE DISCLOSED, REPRODUCED, COPIED OR USED AS THE BASIS OF MANUFACTURE OR SALE OF APPARATUS AND/OR DEVICES, OR OTHERWISE WITHOUT PHILIPS' PRIOR WRITTEN CONSENT.

P/N	DESCRIPTION	QTY.
④ 85-213	SPRING - COMPRESSION- RETURN - SOLENOID	1
85-215	WIRE - LINKAGE - PIVOT ARM - ST	1
86-113	LOCK PLATE ASSEMBLY - HIGH - LE - ST	1
86-133	PIVOT & ROLLER ARM ASSEMBLY - HIGH - LE - ST	1
86-141	SOLENOID ASSEMBLY	1
③ 86-147	LOCKING BAR ASSEMBLY - ST	1
SRHM#10-24X1	SCREW - MACHINE - PAN - #10 UNC x 1	2
NH#10-24	NUT - MACHINE SCREW - #10 UNC	2
WL#10 SPLIT	WASHER - HELICAL SPRING - REGULAR - #10	2
85-178	WASHER - THRUST - 3/8 x 3/4 x 1/16	2
85-177	WASHER - THRUST - 5/8 x 1 x 1/16	2
PC3/32X1/2	PIN - COTTER - 3/32 x 1/2	1
PC3/32X1	PIN - COTTER - 3/32 x 1	1

DRAWING NUMBER:	86-128	REV:	4
ECN NUMBER:	00-089		

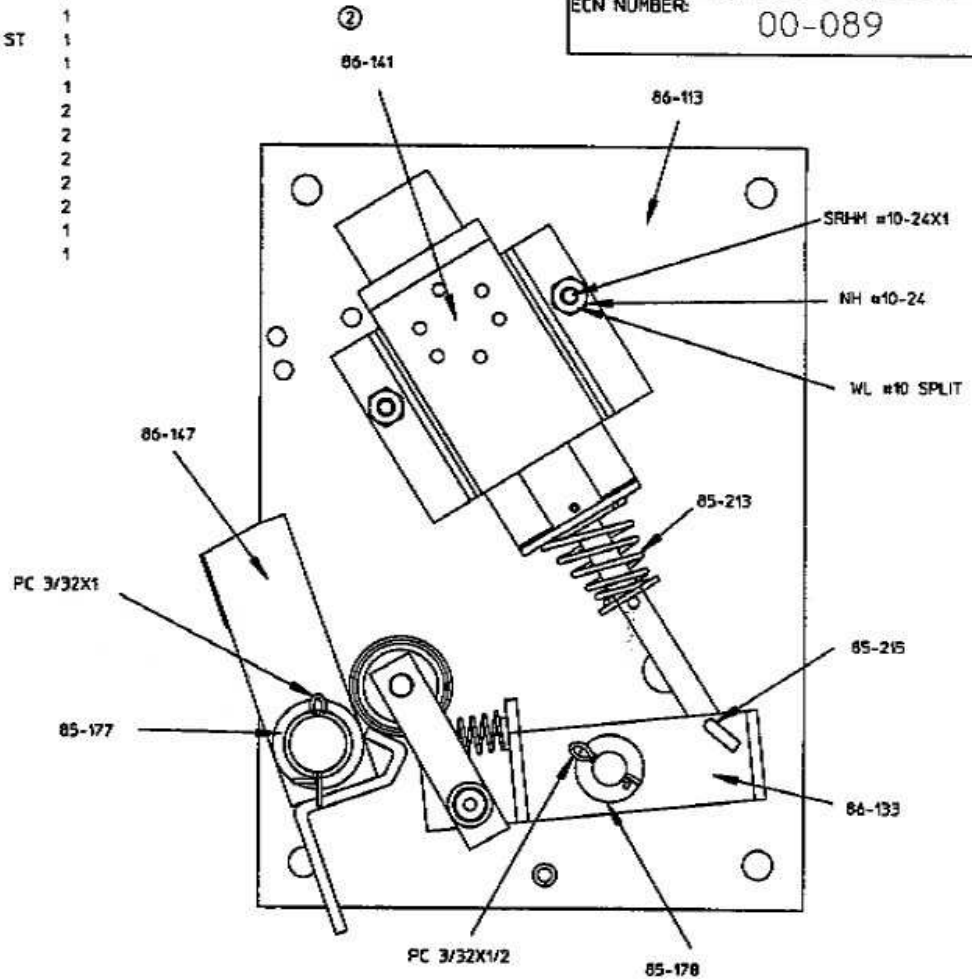

MATERIAL: *****

FINISH: ****

REVISIONS

REV.	DESCRIPTION	BY	DATE
1	UPDATE HARDWARE PART NUMBER DESIGNATIONS	GVB	02/19/99
2	RE-DRAWN AND ELIMINATED ISOMETRIC VIEWS. 86-141 WAS 86-137.	GLS	07/14/99
3	Revised 86-147 Assembly	GVB	03/13/00
4	ADDED 85-213 IDENTIFICATION	CLG	05/22/00

ALL DIMENSIONS ARE IN INCHES UNLESS SPECIFIED

TOLERANCE UNLESS SPECIFIED

0.0	±	0.060
0.00	±	0.030
0.000	±	0.015
0.0000	±	0.005
ANGULAR	±	0.5°

DRAWN BY/DATE: GLS 07/14/99

CHECKED BY/DATE: GVB 07/14/99

Philips CSS Inc
7041 Orchard
Dearborn, MI 48126

DRAWING TITLE:
LOCKING MECHANISM ASSEMBLY - HIGH -
FAIL-LOCK

SIZE:	MODEL:	DRAWING NUMBER:	REV:
A	ST	86-128	4

SCALE: # : # ASSEMBLY ***-*** SHEET: 1 OF 1

THESE DRAWINGS & SPECIFICATIONS ARE THE PROPERTY OF AND PROPRIETARY TO PHILIPS INDUSTRIES, INC. AND ARE NOT TO BE DISCLOSED, REPRODUCED, COPIED OR USED AS THE BASIS OF MANUFACTURE OR SALE OF APPARATUS AND/OR DEVICES, OR OTHERWISE WITHOUT PHILIPS' PRIOR WRITTEN CONSENT.

DRAWING NUMBER: 86-130 REV: 2
 ECN NUMBER: 00-025

P/N	DESCRIPTION	QTY.
85-215	WIRE - LINKAGE - PIVOT ARM - ST	1
86-117	LOCK PLATE ASSEMBLY - HIGH - UE - ST	1
86-135	PIVOT & ROLLER ARM ASSEMBLY - HIGH - UE - ST	1
86-141	SOLENOID ASSEMBLY - UE - ST	1
86-147	LOCKING BAR ASSEMBLY - ST	1
SRHM#10-24X1	SCREW - MACHINE - PAN - #10 UNC x 1	2
NH#10-24	NUT - MACHINE SCREW - #10 UNC	2
WL#10 SPLIT	WASHER - HELICAL SPRING - REGULAR - #10	2
85-178	WASHER - THRUST - 3/8 x 3/4 x 1/16	2
85-177	WASHER - THRUST - 5/8 x 1 x 1/16	2
PC3/32X1/2	PIN - COTTER - 3/32 x 1/2	1
PC3/32X1	PIN - COTTER - 3/32 x 1	1

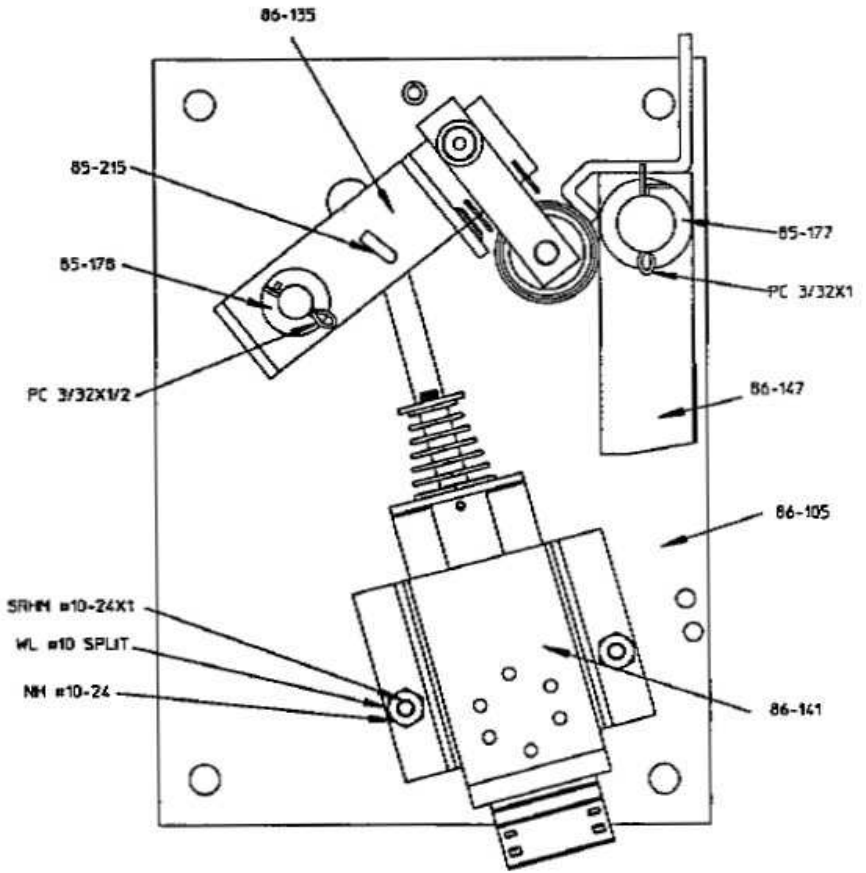

NOTE:
 † 86-135 & 86-147 MUST PIVOT FREELY.

MATERIAL: See Chart
 FINISH: None

REVISIONS				ALL DIMENSIONS ARE IN INCHES UNLESS SPECIFIED		Philips CSS Inc 7041 Orchard Dearborn, MI 48126	
REV.	DESCRIPTION	BY	DATE	TOLERANCE UNLESS SPECIFIED		DRAWING TITLE:	
1	Update Hardware Part Number Designations	GYB	02/19/99	0.0	± 0.060	LOCKING MECHANISM ASSEMBLY HIGH - UE - ST	
2	Eliminate Isometric Views, Revised 86-147 Assembly	GYB	03/15/00	0.00	± 0.030		
				0.000	± 0.015		
				0.0000	± 0.005		
				ANGULAR	± 0.5°		
DRAWN BY/DATE: DMK 08/08/94				SIZE: A	MODEL: ST	DRAWING NUMBER: 86-130	REV: 2
CHECKED BY/DATE: JAK 08/08/94				SCALE: 1 : 2	ASSEMBLY	SHEET: 1 OF 1	

THESE DRAWINGS & SPECIFICATIONS ARE THE PROPERTY OF AND PROPRIETARY TO PHILIPS INDUSTRIES, INC. AND ARE NOT TO BE DISCLOSED, REPRODUCED, COPIED OR USED AS THE BASIS OF MANUFACTURE OR SALE OF APPARATUS AND/OR DEVICES, OR OTHERWISE WITHOUT PHILIPS' PRIOR WRITTEN CONSENT.

Lock Plate Mounting Configurations

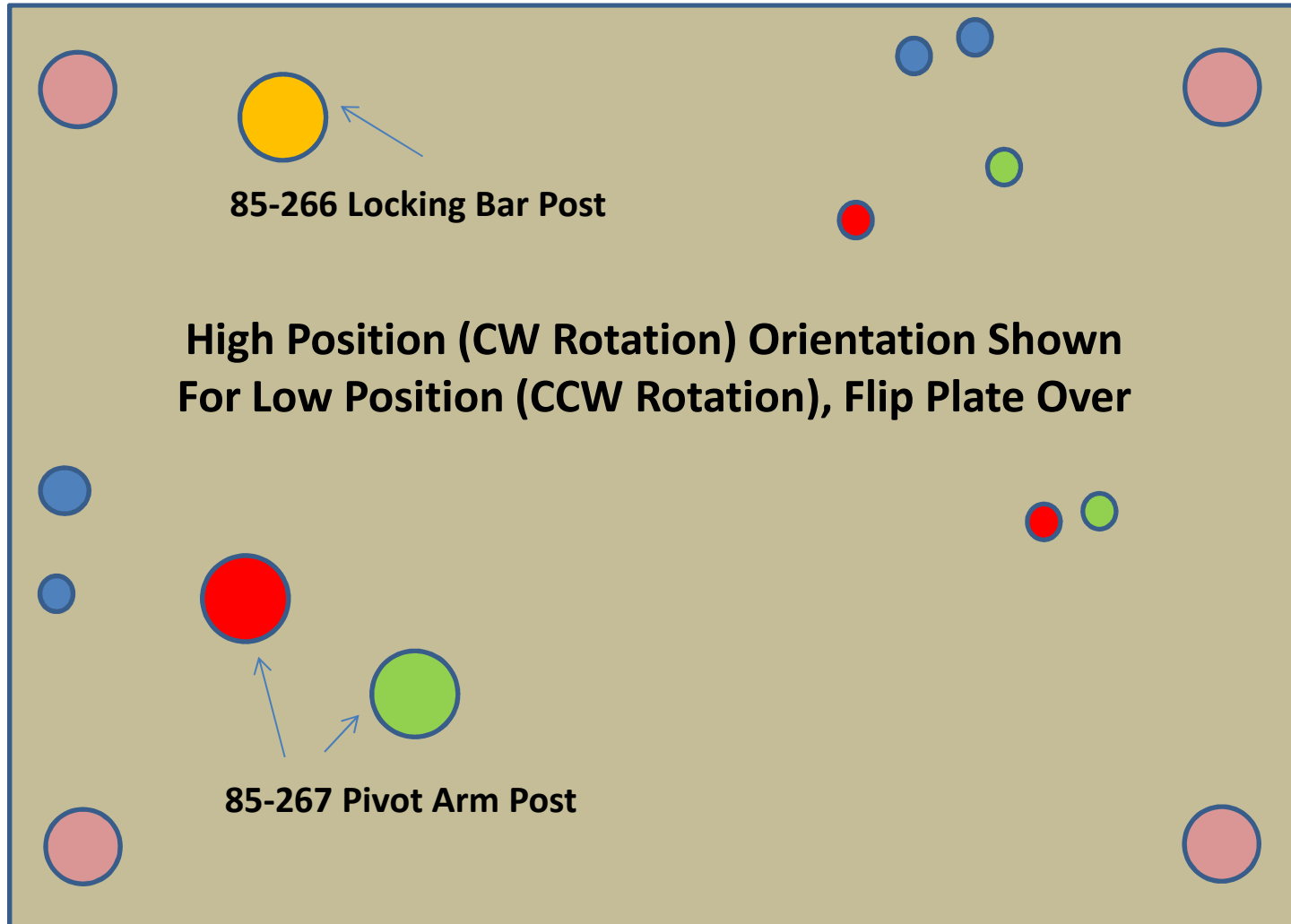

- Locking Bar Post
- Plate Mounting Holes
- Fail Safe Post & Solenoid
- Accessory Mounting Holes
- Fail Lock Post & Solenoid

Lock Plate Configurations

	86-127 Low Fail Lock CCW	86-128 High Fail Lock CW	86-129 Low Fail Safe CCW	86-130 High Fail Safe CW
Complete Lock Plate Assy	86-105	86-113	86-116	86-117
Locking Bar Assy	86-147	86-147	86-147	86-147
Locking Bar Post	85-266	85-266	85-266	85-266
Pivot & Roller Arm Assy	86-132	86-133	86-134	86-135
Pivot Arm Post	85-267	85-267	85-267	85-267